



# Smart Reservoir

**Variable Volume Reservoir**

**Filling & closed loop filtration unit**

# Filling & closed loop filtration unit



This unit can be used to fill the reservoir and hydraulic network. Then by the action of a 3 way ball valve it can serve as a closed loop filtration unit.

## Specifications

- 12Vdc / 5A or 24 Vdc / 2.5 A (tol. +25% \*)
- Continuous duty military grade heavy duty DC motor
- 2 to 3 GPM (7,6 to 11,4 l/min.) spur gear type
- 50 PSI (3,4 bar)
- 3/8" NPT inlets (2) & outlet
- 350°F (175°C)
- Spin on filter cartridge; 3 micron  $\beta_3 \geq 200$
- 13.5lb (6,1 kg)
- 16" H x 8" x 8" ( 40,6cm H x 20,3cm x 20,3cm)

-Part # TWX-300-F-SO3-MP-12V

-Part # TWX-300-F-SO3-MP-24V

\* Fuse or breaker required;

12 Vdc → 20A

24 Vdc → 10A

# Features

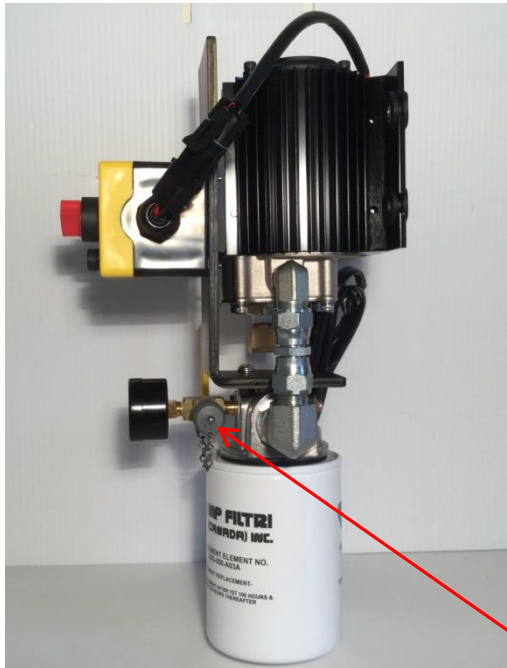
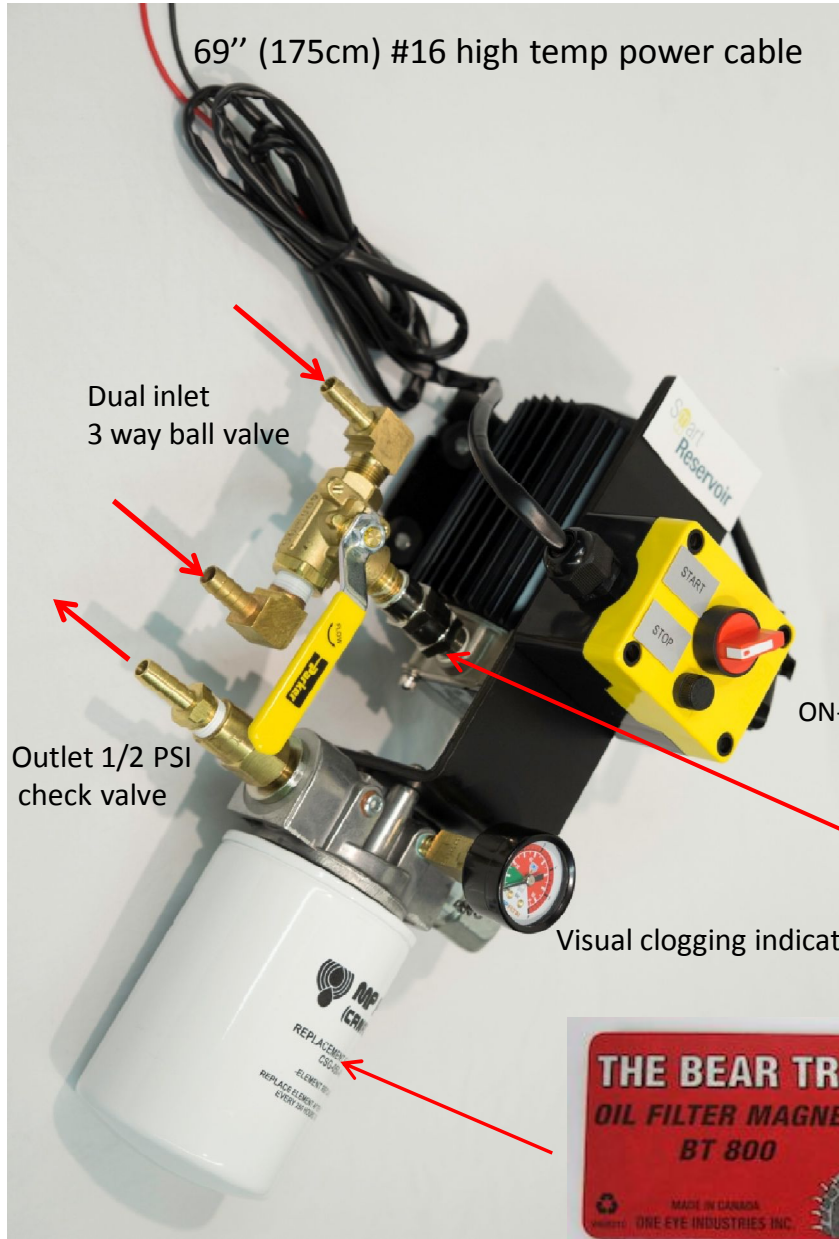

Mounting pad with anti-vibration grommets

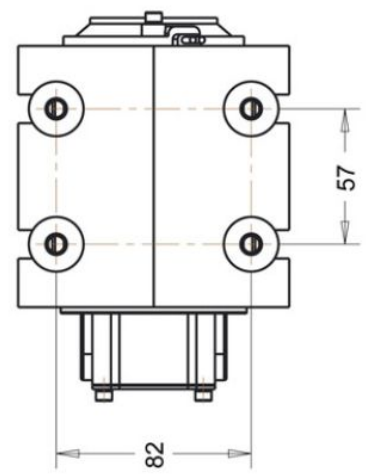

ON-OFF switch with fuse

150µ SS Inlet filter for pump protection can be put apart for cleaning



Visual clogging indicator



Magnetic pad is added on the filter housing to capture submicron ferrous contaminants

## The unit can also be used to help VVR system air bleeding

Circuit layout example

